

**INSPIRED BY THE EARTH**

As consideration for the natural landscape and its inhabitants increases with new technologies making sustainable design more feasible, so too has nature's ability to inspire architecture and design. Ho Chi Minh City-based Vo Trong Nghia Architects explores this concept through its bamboo lotus-inspired pavillion, based on the beauty and growth cycle of Vietnam's national flower. In Bligh Tanner's award-winning installation design, the anatomy of the human body is called upon with a cochlear-inspired design, using Corten, stainless steel and rock to ground the design back to nature. Planex's new Storage Guide includes office furniture that facilitates the installation of indoor greenery, while Casamania calls on its green thumb to create a table with subtle reference to a wheelbarrow.

**The Storage Guide 3rd Edition**

Now available from Planex  
 Pictured 'S-series' cabinet  
 with flox planter top  
[planex.com.au](http://planex.com.au)



**National Winner - Freefall  
 Experience Design  
 Ideas Competition**

Bligh Tanner Engineers  
[blightanner.com.au](http://blightanner.com.au)

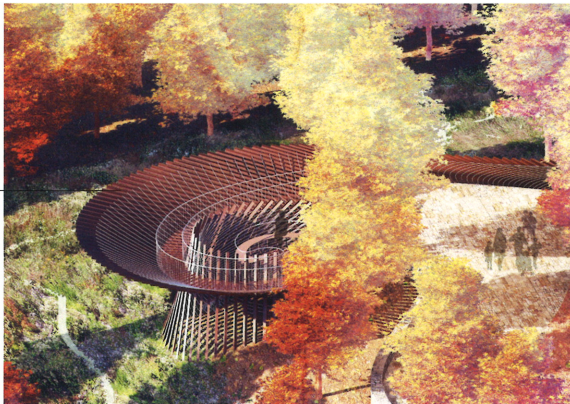

**Vitnam Pavillion for  
 Milan World Expo 2015**

Lotus Inspired Design  
 Vo Trong Nghia Architects  
[votrongnghia.com](http://votrongnghia.com)



**'Dot'**  
 Casamania  
 available at Cafe Culture Insitu  
[cafecultureinsitu.com.au](http://cafecultureinsitu.com.au)